

Brass Swing Check Valve (CV)

Features

- Heavy duty brass construction
- Swing type
- Horizontal or vertical installation
- 200 WOG
- Available with threaded or solder ends
- Five-year warranty
- Available in lead-free

DIMENSIONS

Threaded

Item No.	Size	L (mm)	H (mm)
CV-050	1/2"	53	54
CV-075	3/4"	60	58.5
CV-100	1"	66.5	66.5
CV-125	1 1/4"	81	78
CV-150	1 1/2"	90	87
CV-200	2"	107	107
CV-250	2 1/2"	130.5	126.5
CV-300	3"	146.5	153
CV-400	4"	173.7	195

Solder

Item No.	Size	L (mm)	H (mm)
CV-050S	1/2"	61	54
CV-075S	3/4"	80	58.5
CV-100S	1"	89	66.5
CV-125S	1 1/4"	105.5	78
CV-150S	1 1/2"	116	87
CV-200S	2"	139	107



CV



CVS

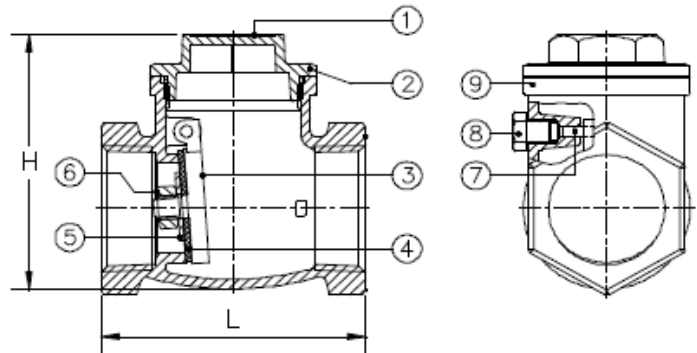

MATERIAL SPECIFICATION

No.	Parts	Materials
1	Name Plate	Aluminum (A1100)
2	Cap	Brass (ASTM-UNS B584 C85710)
3	Disc/Holder	Brass (ASTM-UNS B584 C85710)
4	Seat Packing	Brass (ASTM-UNS B584 C85710)
5	Washer	Brass (ASTM-UNS B584 C85710)
6	Seat Nut	Brass (ASTM-UNS B16 C36000)
7	Pin	Brass (ASTM-UNS B124 C37700)
8	Lock Bolt	Brass (ASTM-UNS B16 C36000)
9	Body	Brass (ASTM-UNS B584 C85710)