

Dielectric Union (DU)

Female Iron Pipe x Solder-Flanged

Features

- Galvanized x Brass
- Maximum working water pressure: 250 PSI
- Maximum working water temperature: 210°F
- Thread connections: ANSI B1.20.1
- Copper connections: ANSI 16.18
- Available in sizes: 1/2" - 2"
- IAMPO/UPC-NSF 61.4/AB1953 listed

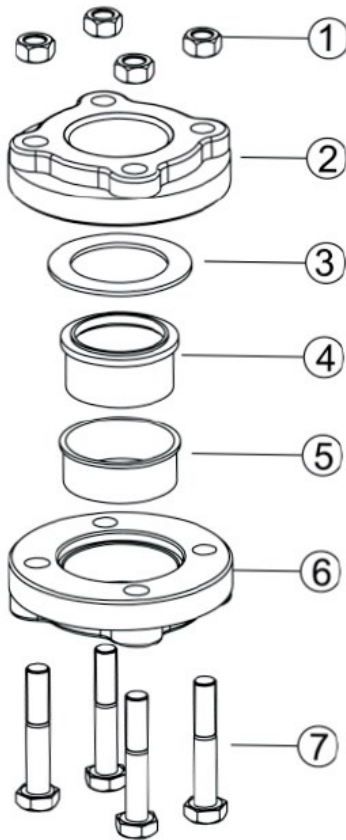

MATERIAL SPECIFICATION

No.	Parts	Materials
1	Nut	Steel
2	FIP Flange	Ductile Iron
3	Washer	EPDM
4	Solder Adapter	Cast Brass
5	Insulator	Nylon
6	Flange	Ductile Iron
7	Bolt	Steel

Dimensions

Part No.	Nominal Size	A-Solder	B	C	D-FIP
DU1350	2 1/2" x 2 1/2"	2-1/2"	3-7/8"	5-5/8"	2-1/2"-8NPT
DU1351	3" x 3"	3"	3-7/8"	6-5/8"	3"-8NPT
DU1352	4" x 4"	4"	-	-	-

